

**Fountain Planter Layout**

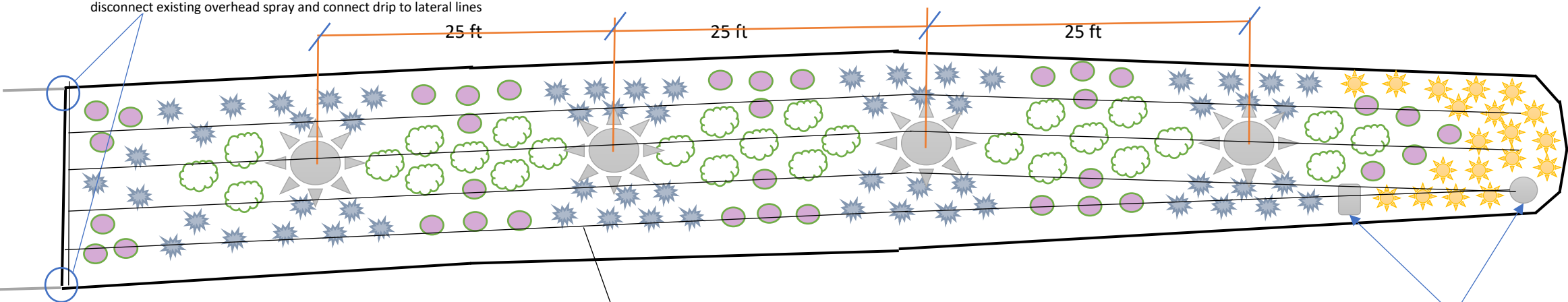

Size	Qty	symbol	Plant Name
5-gal	40		Raphiolepis Umbellata
36" box	4		Fruitless Olive 'swan hill'
1-gal	35		Nepeta Catmint
1-gal	130		Dianella 'baby bliss'
JBO	9 flats		annual flowers

Drip lines 4 rows of lateral  
 1-gal 1 emitter  
 5-gal 2 emitters  
 36" box 4 bubblers

Utility boxes or lids

**CITY OF MORGAN HILL**  
**PLAN APPROVED**

THIS PLAN WAS APPROVED BY  
 THE PLANNING DIVISION

ON 1/25/2022

SR2021-0017  
 FILE NUMBER

PLANNING OFFICIAL

**SR2021-0017: SUTTER – COCHRANE BUSINESS RANCH:** a request for a design permit to remove the existing water fountain within the median on Sutter Boulevard and replace it with water efficient landscaping. The project is located within the landscaped median north of Cochrane Road and Sutter Boulevard intersection. CEQA: Categorically Exempt pursuant to Section 15304(b) for Minor Alterations to Land.

Impervious Surfaces	Proposed Surfaces		Total Proposed Impervious Surface
	New <sup>1</sup>	To Be Replaced <sup>2</sup>	
Roof Area	0	0	0
Parking	0	0	0
Sidewalks, Patios, Driveways, Etc.	0	Approximate 300 sq.ft.	Removal of water fountain and replaced with landscaping
Public or Private Streets	0	0	
<b>Impervious Surface Total</b>			

1. Proposed New Impervious Surface: New impervious surface what will cover an existing pervious surface.
2. Proposed Replaced Impervious Surface: Replacement of an existing impervious surface with another impervious surface.

Total Proposed Impervious Surface (TPIS) is less than 2,500 sq.ft. Therefore the project is exempt from the Stormwater Post-Construction requirements.

